

Fitup

Fitup Create

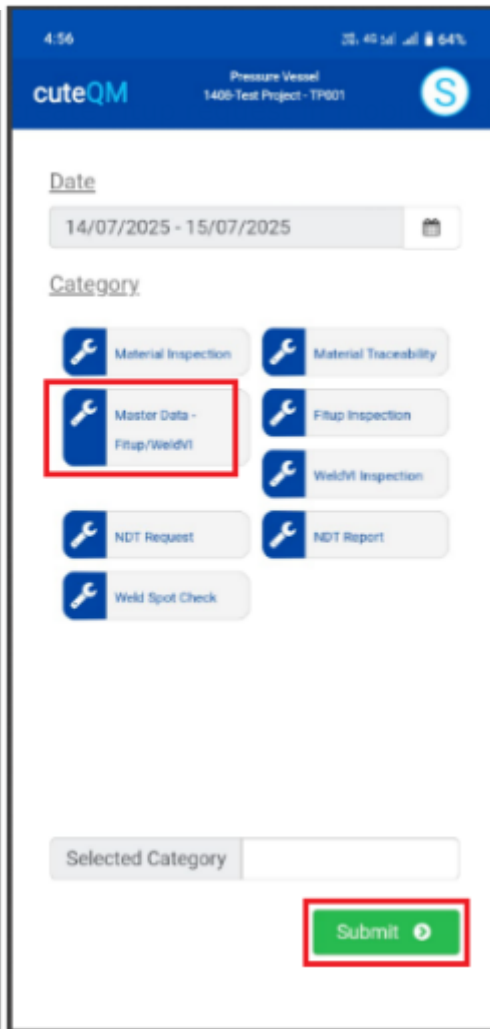
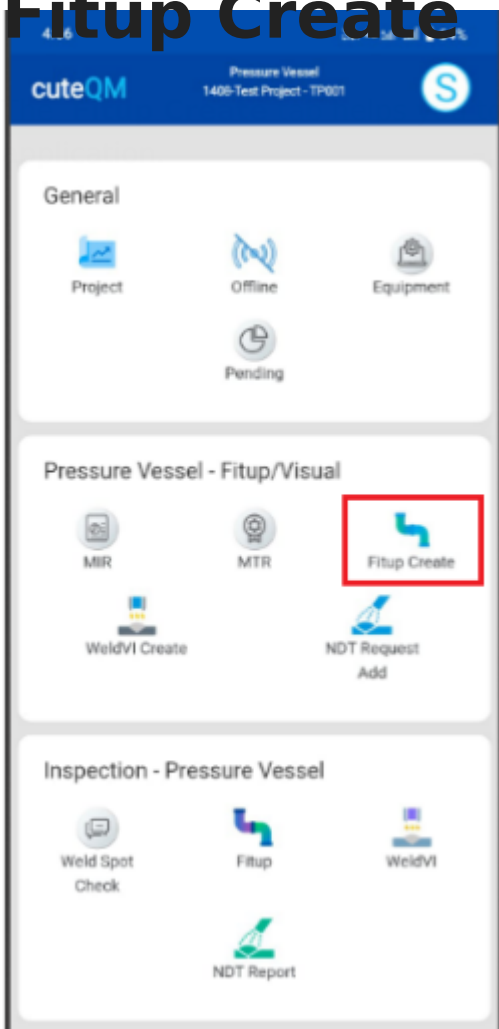

sync the details to the web

Before Fitup PT/MT/EP not complete

N/A
Location
N/A

L.S JD32

WPS : WPSS01

Thickness1	Thickness2	Joint Length
0	0	0



PartNo1
101

PartNo2
101

Date : *
01/06/2026

Fitup-Completed : *

Location

L.S JD32

WPS : WPS/24.022/02

Jd32

MTR - Heat number not mapped

Before Fitup PT/MT/EP not complete

L.S JD32

WPS : WPSS01

Thickness1	Thickness2	Joint Length
0	0	0



PartNo1
101

PartNo2
101

Date : *
01/06/2026

Fitup-Completed : *

Location
N/A

To **create Fitup** request,do the following

1. Take **offlinedata** for **Master Data-FITUP/WeldVI**.
2. Click **Fitup Create** menu
3. Here joints listed to create the **Fitup**
4. Select the **joints**
5. Enable **Fitup completed** toggle button
6. Click **Save**

Fitup request created successfully.

Click **Sync** button at the top to sync data to web manually.Otherwise it will be synced automatically.

Fitup Inspection

For fitup inspection,do the following steps



Project



Offline



Equipment



Pending

Pressure Vessel - Fitup/Visual



MIR



MTR



Fitup Create



WeldVI Create



NDT Request
Add

Inspection - Pressure Vessel



Weld Spot
Check



Fitup



WeldVI



NDT Report

Joint Number

LS

WPS : ROS-WPS-01

Fitup-Date :
14/07/2025

Location
ALL

A12



1. Take **offline** data for **Fitup Inspection**.
2. Click **Fitup** menu in inspection
3. Here fitup inspection created joints listed
4. **Select** the joint
5. Enable **inspection** toggle button
6. Select **heat number 1** and **heat number 2** and **Result**
7. Click **Save** button placed at the bottom

Fitup inspection updated successfully.

Click **Sync** button at the top to sync data to web. Otherwise it will be synced automatically.

Revision #2

Created 1 June 2026 12:38:46 by Shybin

Updated 1 June 2026 13:43:15 by Shybin