

# Mobile App - Pressure Vessel

- User Management
- Take Offline Data
- Fitup
- Weld Visual

# User Management

## 1.1 Downloading *cuteQM* app

To use the *cuteQM* app you must first download it from the **Play Store**.

1. Open the **Play Store** and search for "*cuteQM*".
2. Download and install the *cuteQM* app on your mobile phone.
3. After installation, open the *cuteQM*

*You are ready to go!*

## 1.2 Log in

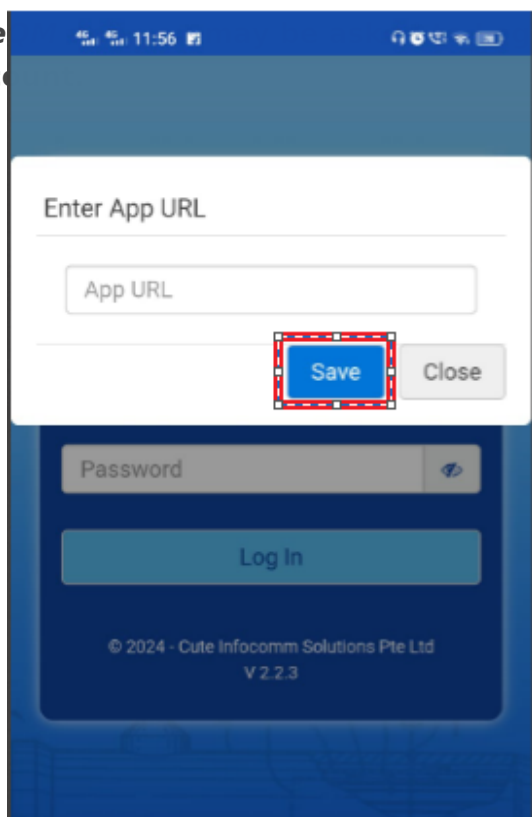

1. Before enter your user id and password, tap  (Settings icon) and enter the app URL <https://apiassurex.temaindia.com> .

2. Tap **Save**.

3. Enter your user id and password in the allocated fields.

4. Tap **Log in** to complete the process.

The home screen of the **cuteQM** app is appeared.

## 1.3 Home screen of **cuteQM** app

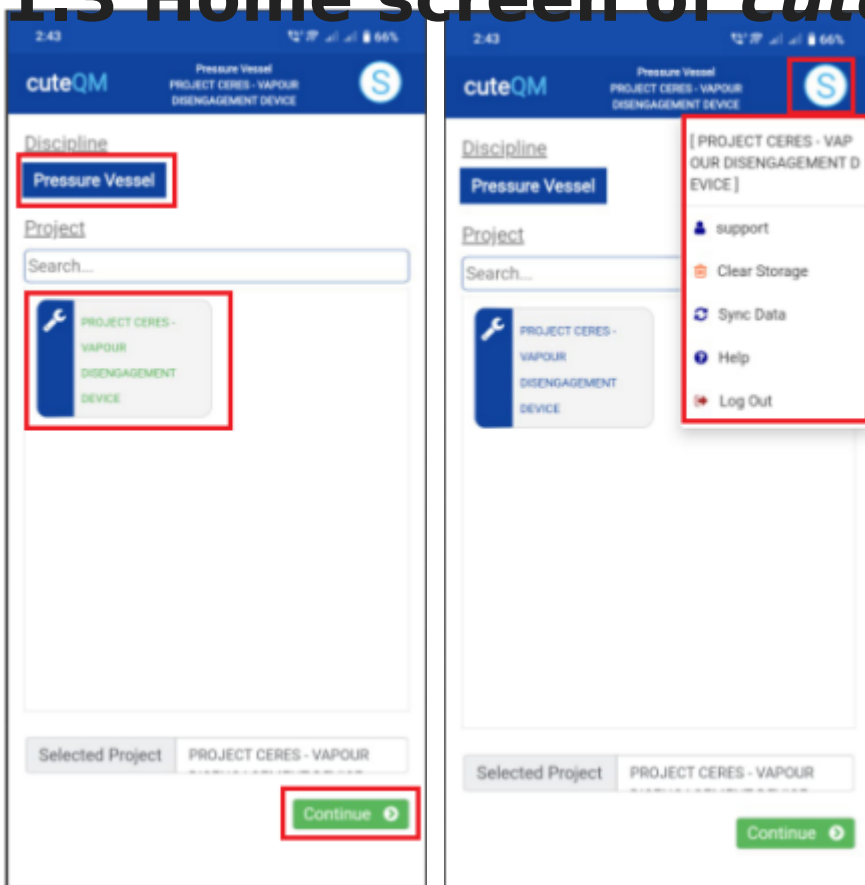

1. **Module** – helps to select the module. Select pressure vessel module
2. **Project** – Helps to select the project. select the project.
3. Click **Save** button to go to the menu screen.

 (show/hide icon) helps to show/hide the user id information that is displayed in the right panel of the home screen. If you touch this icon the information appears on, if you touch this icon again the information goes off.

- **Clear Storage** - clears all data in this app. Tap the **Clear Storage** option to delete all the data.
- **Sync Data** - synchronizes your inspection results with the respective reports in the web application. If your inspection results are not automatically synchronized with the web application, tap the **Sync Data** option for manual synchronization.
- **Log out** - To log out from the cuteQM app.

# Take Offline Data

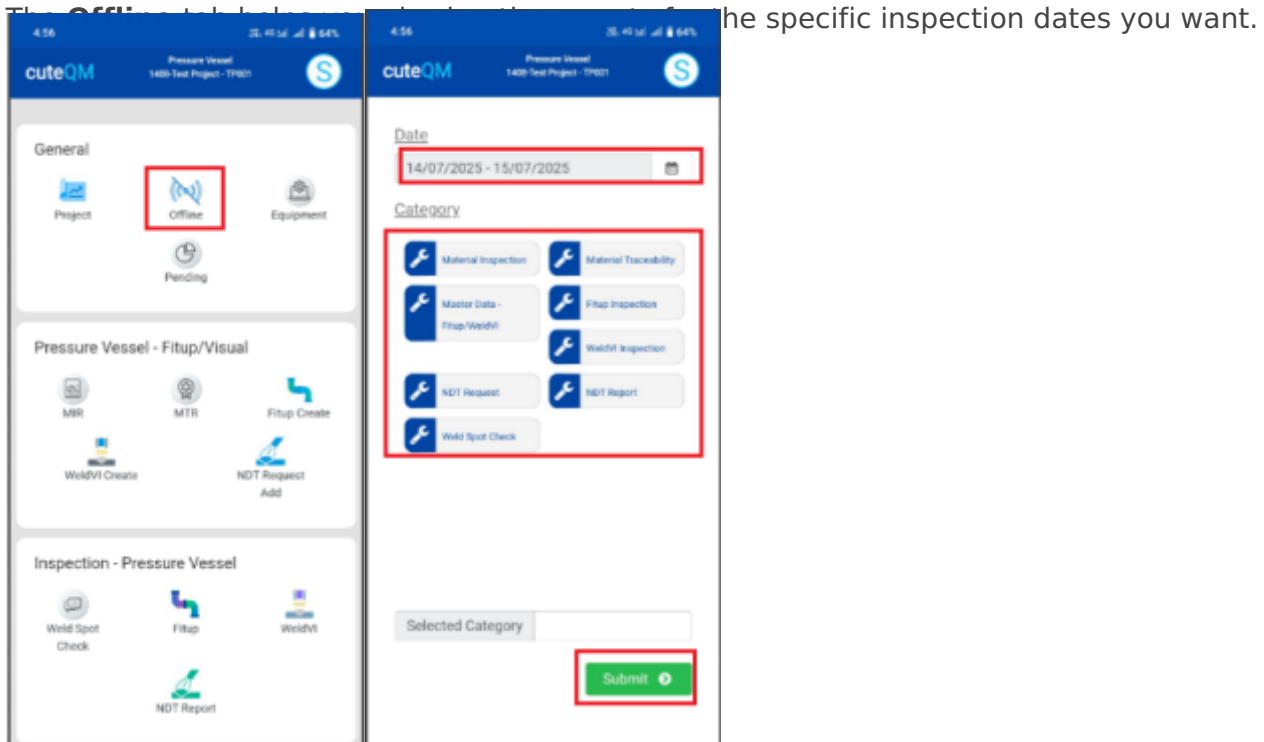

Do the following steps to take offline date

1. Click **Offline** menu. A new window opens for selecting category and date you want.
2. In the **Date** box, choose the period by selecting respective dates.
3. In the **Category** box, tap and select the option you want.
4. Click **Submit**

**Offline data stored successfully.**

# Fitup

## Fitup Create

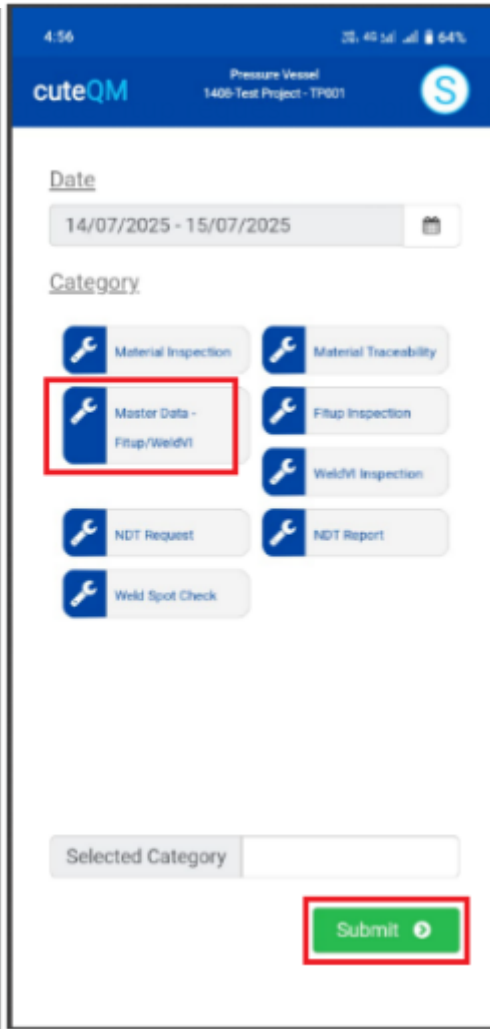
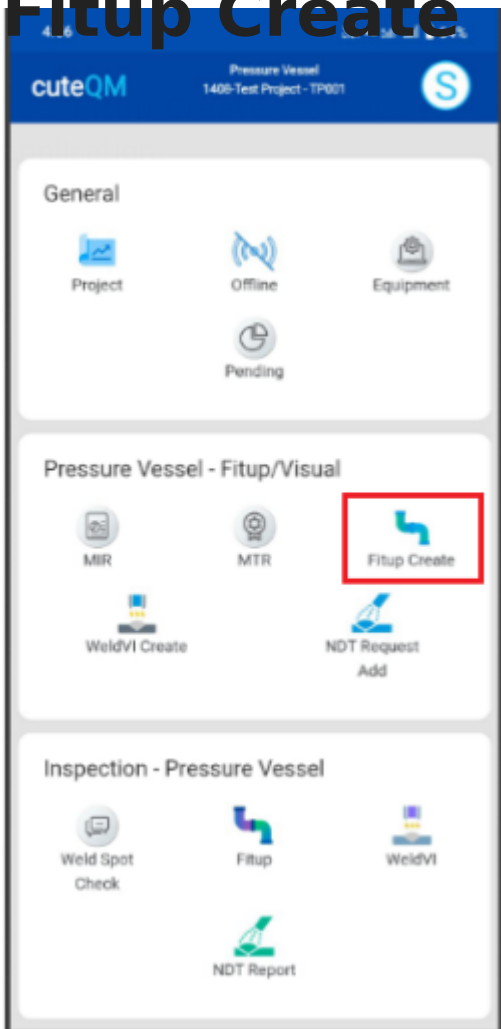

sync the details to the web

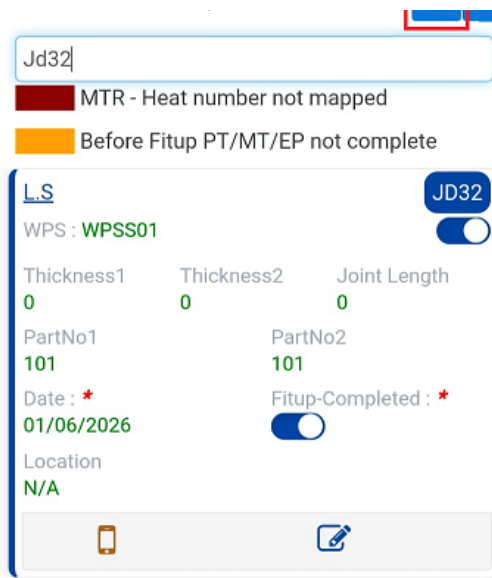
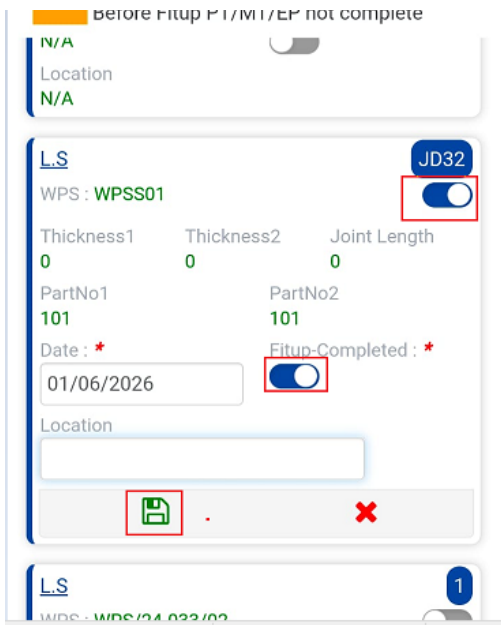

To **create Fitup** request,do the following

1. Take **offlinedata** for **Master Data-FITUP/WeldVI**.
2. Click **Fitup Create** menu
3. Here joints listed to create the **Fitup**
4. Select the **joints**
5. Enable **Fitup completed** toggle button
6. Click **Save**

**Fitup request** created successfully.

Click **Sync** button at the top to sync data to web manually.Otherwise it will be synced automatically.

## Fitup Inspection

For fitup inspection,do the following steps



Project



Offline



Equipment



Pending

### Pressure Vessel - Fitup/Visual



MIR



MTR



Fitup Create



WeldVI Create



NDT Request  
Add

### Inspection - Pressure Vessel



Weld Spot  
Check



Fitup



WeldVI



NDT Report

Joint Number

LS

WPS : ROS-WPS-01

Fitup-Date :  
14/07/2025

Location  
ALL

A12



Inspection Date : 14/07/2025 Inspection :

AI Hold :  AI Cleared :   
 Client Cleared :  Client Hold :   
 Owner Cleared :  Owner Hold :

Material HeatNo1 :

Material HeatNo2 :

Result \* Accepted AI Remarks :

Client Remarks :  Owner Remarks :

Component Details :

Comments :

Save Close

C.S C7

WPS : WPS101

Fitup-Date : 15/07/2025      Location : ALL

☰ ✎

1. Take **offline** data for **Fitup Inspection**.
2. Click **Fitup** menu in inspection
3. Here fitup inspection created joints listed
4. **Select** the joint
5. Enable **inspection** toggle button
6. Select **heat number 1** and **heat number 2** and **Result**
7. Click **Save** button placed at the bottom

Fitup inspection updated successfully.

Click **Sync** button at the top to sync data to web. Otherwise it will be synced automatically.

# Weld Visual

## WeldVI Create

The **WeldVI create** tab helps you to create weld visual request in mobile and sync the details to the web application.

To create Weld visual request,do the following steps

1. Click **weldvi create** menu
2. **Select** the joint
3. Enable the toggle button as **Completed**
4. Click **+ icon** to add welder details
5. Click **Save** button

**Weldvi request** created successfully.

Click **Sync** button at the top to sync data to web. Otherwise it will be synced automatically.

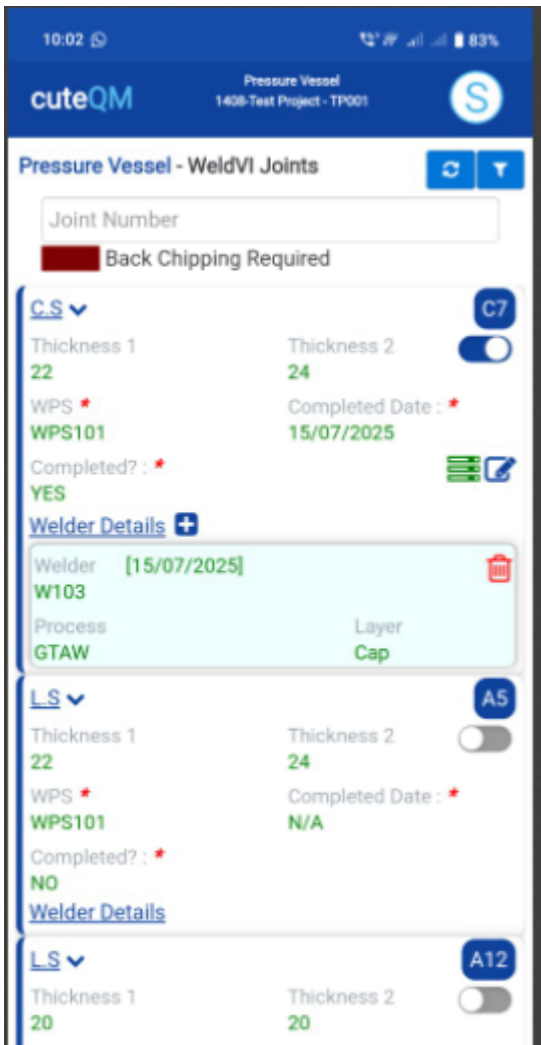
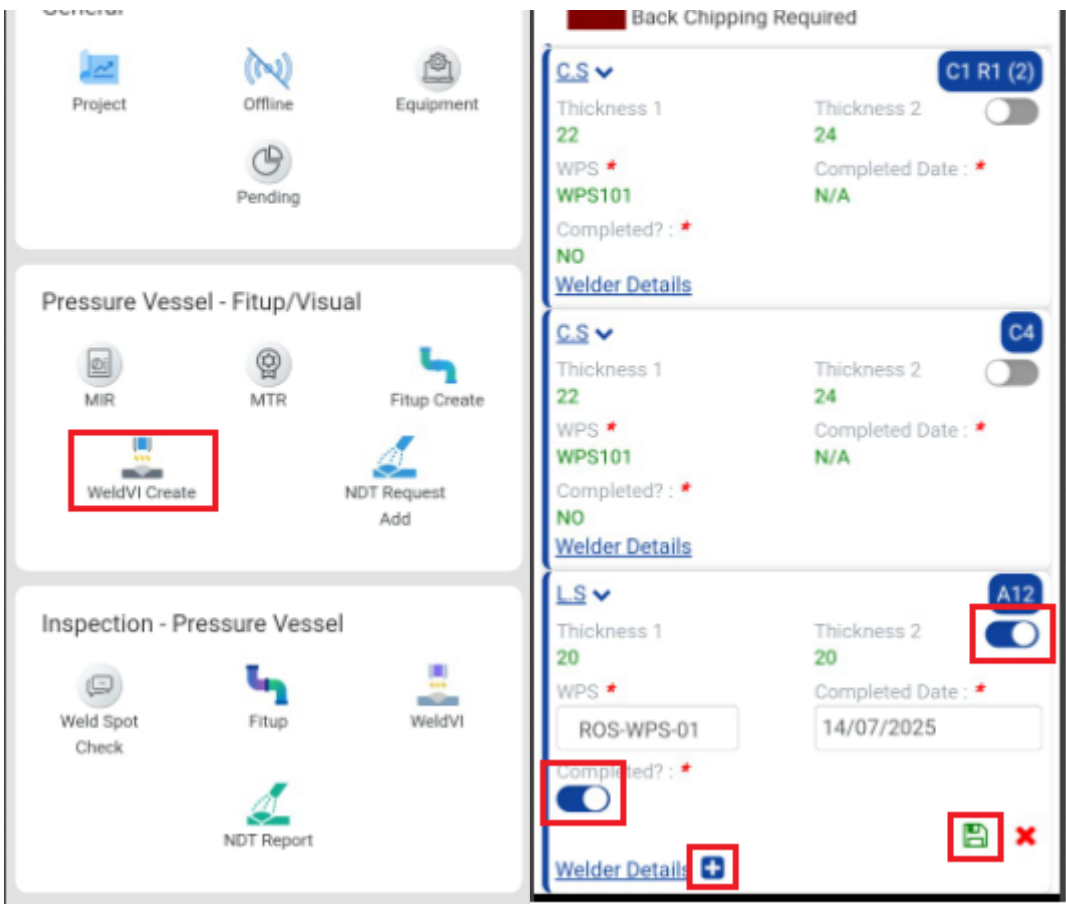

# WeldVI Inspection

For **weld visual inspection**,do the following steps.

1. Click **Weldvi** menu in inspection
2. **Select** the joint
3. Enable the **Inspection** toggle button
4. Select the result as **Accepted**
5. Click **Save**

**WeldVI** inspection updated successfully.

Click **Sync** button at the top to sync data to web.Otherwise it will be synced automatically.

